

Product: High Power Optical Isolator

Part Number	Spec Number	Version	Date
HISOXXXXXXXXXX	S073	Rev 01	11/06/2023

1 Specifications

Item	Parameters	Symbol	Value	Units	Note
1.	Center Wavelength (λ_c)	λ_c	1940 or Specify	nm	
2.	Operating Wavelength Range	λ_{op}	$\lambda_c \pm 10$	nm	
3.	Typ. Insertion Loss, 23 °C	IL	1.0	dB	
4.	Max. Insertion Loss, 23 °C	IL	1.4	dB	
5.	Typ. Peak Isolation, 23 °C	IS	30	dB	
6.	Min. Isolation, λ_c , 23 °C	IS	26	dB	
7.	Max. Polarization Dependent Loss, 23 °C	PDL	0.2	dB	
8.	Min. Return Loss	RL	50	dB	
9.	Max. Optical Power	Pop	20	W	
10.	Max. Peak Power for ns Pulse	Pp	10	kW	
11.	Fiber Type		SM-GDF-10-130-15M or Specify		
12.	Operating Temperature	Top	-5 to 70	°C	
13.	Storage Temperature	Tstor	-40 to 85	°C	

Note:

* IL is 0.3 dB higher, RL is 5 dB lower and Optical Power is 1 W only for each connector added.

2 Drawings

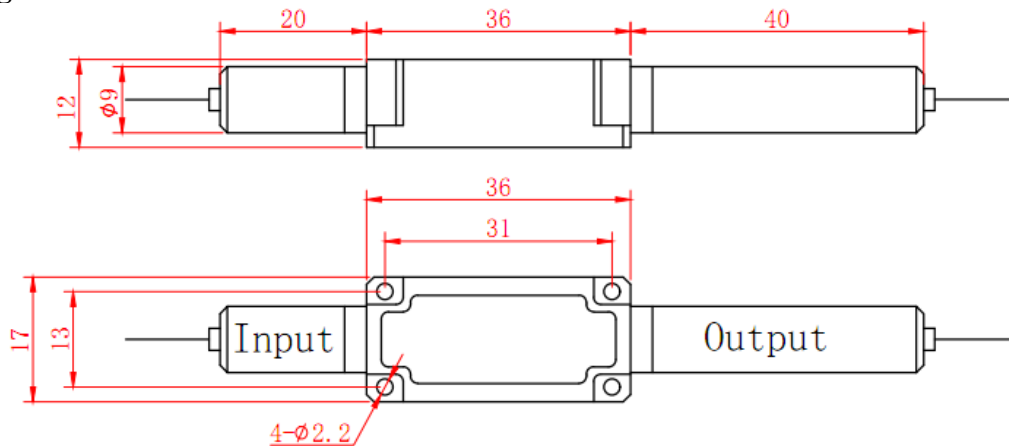

3 Device Label, Delivery Data, RoHS Requirement

Triple-Stone standard format. RoHS compliant.

4 Order Information

HISO-1-2-3-4-5-6-7

1.	Wavelength	1940 - 1940 nm, 1950 - 1950 nm, 2000 - 2000 nm, SSSS - Specify
2.	Handling Power	10 - 10 W, 20 - 20 W, SS - Specify
3.	Fiber Type	1 - SMF-28 fiber, 2 - SM1950, 3 - SM-GDF-10-130-15M, 4 - BD-G25/250-11FA, 5 - LMA-GDF-25/400-09M, 6 - CJGDF-10/130-T, S - Specify
4.	Fiber Length	1 - 1.0 m, S - Specify
5.	Jacket Type	B - Bare fiber, L - 900 μ m loose tube, S - Specify
6.	Connector Type	N - None, S - Specify
7.	Power Type	C - Continuous Wave, P - Pulse Application